

LAW FIRM
SUSTAINABILITY

NETWORK

PROMOTING SUSTAINABILITY



Webinar Session: Reopening Business Safely & Sustainably

Thursday, May 21, 2020
12PM ET



Our Panelists



Jennifer Taranto

Director of Sustainability
Structure Tone
617.956.3721
jennifer.taranto@structuretone.com



Gail Ruopp

Law Firm Manager
609.216.4614
gruopp1@gmail.com



Kevin Kennedy

Executive Vice President
Arenson
917.379.5796
kkennedy@aof.com



Richard Colucci

President
Distinctive Offices
917.416.6161
richard@distinctiveoffices.com



Ricky Dweck

Executive Vice President
ECS Global Services
732.688.9000
ricky.dweck@enerconsupply.com



Marc Siegel

Weeks Lerman
516.637.3544
msiegel@weekslerman.com



Mirian Ortega

Complex Director of Sales
Le Meridien New York Central Park
917.935.8772
mirian.ortega@lemeridiennyc.com

#HealthyBuildings

What do I need to know?

Indoor Air Quality

System Considerations	Recommendation
Air Filtration	Minimum MERV13 and consider MERV15
Air Exchange / Fresh Air Rates	Fresh air rates up to 30% higher than code minimum and/or HVAC design with 100% outdoor air; Air change rates to be evaluated/optimized with CFD analysis
Humidity Control	Year-round humidity between 40-60%, which would require active humidification during heating mode
Pressurization	Pressurize to induce airflow from one space to another; design for maximum fresh air in occupied zones
Ultraviolet (UV) Light	Reference ASHRAE guidance for UV integration, taking care with shielding requirement to prevent direct exposure to human tissue/eyes
Air Quality Monitoring	Take advantage of growing monitoring options to support continued tracking of air quality

Reference: [Buro Happold, Engineering Healthy Workplaces News Feed](#)

Cleaning



- High and low touch areas
 - What's the plan?
 - Transparency.
 - Supplemental cleaning?
 - Training
 - Purchasing policy
- Cleaning products
 - Again, transparency.
 - Balance safety with human health

Wellbeing

At least **one in five workers** experience common mental health problems, including anxiety and depression.

71% of adults reported at least one symptom of stress, such as a headache or feeling overwhelmed or anxious.



Reference: [CDC, Mental Health in the Workplace](#)

Maintaining Sustainability



- Increase cleaning vs. disposability
- Increase bicycle infrastructure and promote shared bike programs
- Promote reusable masks

Contact

- Jennifer Taranto
Director of Sustainability
Structure Tone
jennifer.taranto@structuretone.com
 @jenntaranto

Initial Procedures When Returning

- ▶ to Work

RTW (Return to Work) Committee



- ▶ **Create a committee to police new policy compliance**
- ▶ Be sure to include:
 - ▶ A partner who is respected by the majority of the firm
 - ▶ A member of administration - preferably the Director of Administration
 - ▶ A trusted associate
 - ▶ A trusted paralegal
- ▶ Be prepared to institute fines for noncompliance which may include but are not limited to reductions in year-end discretionary bonuses.
- ▶ It may become necessary for the committee to internally publicize offenders.

Basic Initial Policies



- ▶ Set up an iPad with a questionnaire that ALL people entering the office must answer. An online version of the questionnaire should be made available to employees.
- ▶ Prepare a seminar in which all employees must participate prior to returning to the office.
- ▶ Prepare an RTW policy that all employees must review and sign.
- ▶ There must be no penalty for an employee who states that he/she needs to work from home or needs to go home early.
- ▶ Human Resources department must have a list of hotlines for mental health organizations.

Stay Tuned.....

- ▶ Expect things to change.
- ▶ No one will win a gold medal for requiring their workforce to return to the office sooner rather than later.
- ▶ Expect approximately 50% of your workforce to work remotely going forward.

Gail Ruopp

www.gailruopp.com

609-216-4614

gruopp1@gmail.com



Law Firm Sustainability Network

ALA NYC

Association of Legal Administrators

Creating Safe Zones

*How Arenson can help you prepare to
return to your office.*

Rosemary Farrell
Senior Account Executive
516.707.1955 **direct**
rfarrell@aof.com

Kevin Kennedy
Executive Vice President
917.379.5796 **direct**
kkennedy@aof.com

Arenson

Given the current health concerns created by COVID-19, we have researched how furniture can be adapted to provide Safe Zones. After reviewing your furniture typicals and layouts Arenson can help you in creating these Safe Zones.

Keeping You Safe

Workplace Assessment

- Dimensionalize the workspace
- Understand people flow
- Evaluate communal & collaborative areas

Government & Company Policy

- Discuss and understand company Policy for re-entry
- Understanding Federal, State and Local guidelines

Creating Safe Zones

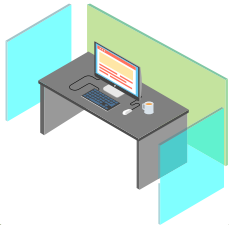

Process / Recommendations

- Understand and develop protocols.
- Develop goals and consider options to achieve them.
- Consider cost alternatives.
- Develop people flow and graphic package.
- Comply with and implement government guidelines protecting both the Company and the Employees.

The Process:

- The Arenson audit determines weaknesses or hotspots for consideration.
- The Arenson process and assessment phase determines how those weaknesses can be mitigated.
- The solutions or recommendations are determined from a vast inventory of alternatives, the selection of which is determined by discussing and understanding the clients drivers. Cost, Aesthetics, Permanence, Schedule, and Governance must all be considered.

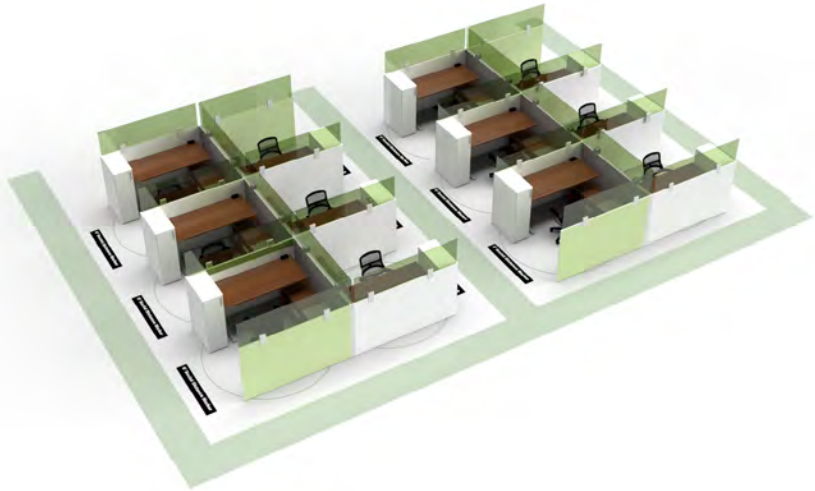
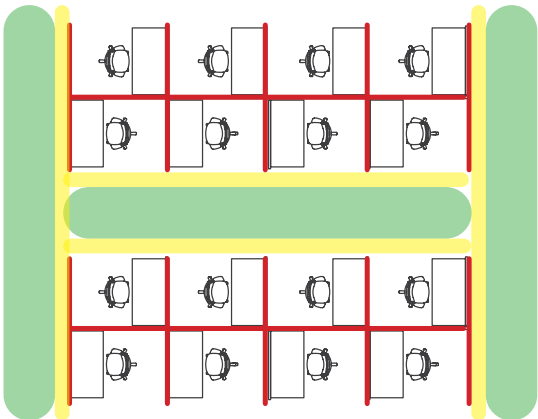

“Restructuring the workplace to meet CDC guidelines with either temporary or permanent solutions is a task that must be done before contemplating going back to the office.”

The New York Times



What to Expect:

- Areas to Consider (Color-coded floorplans)
- Circulation Flow with arrows.
- Instructional graphics to assist employees.

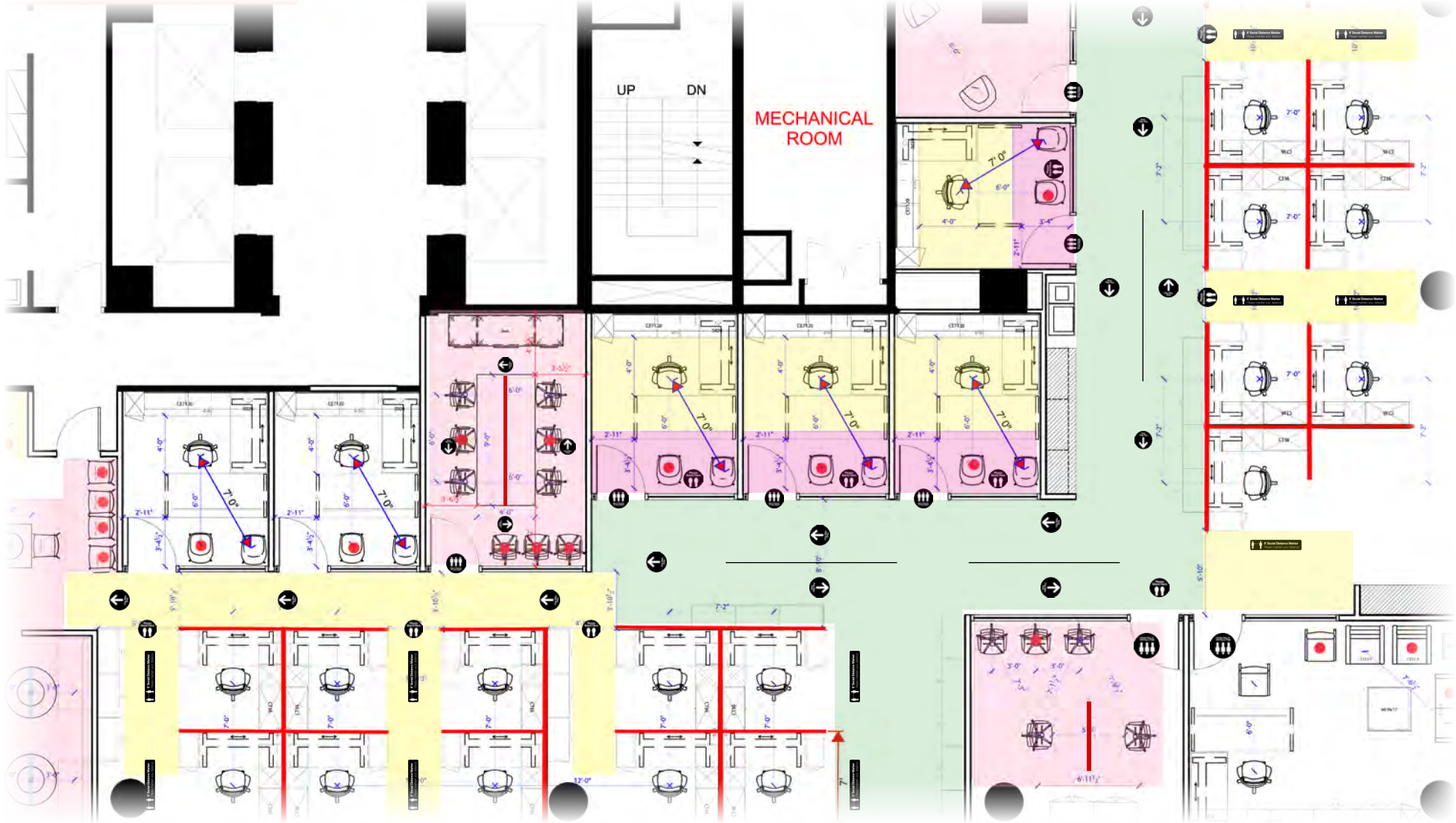

Arenson | Color Key

Green Areas

Areas that would be 6' compliant

Yellow Areas

Cautionary areas that should be reviewed for 6' distancing

Red Areas

Areas not compliant with 6' distancing.

Red Lines

Areas for increase in panel heights or screen additions

Red Dots

Ancillary items that should be removed to create social distance

Solutions

The following pages show some examples of creating Safe Zones.

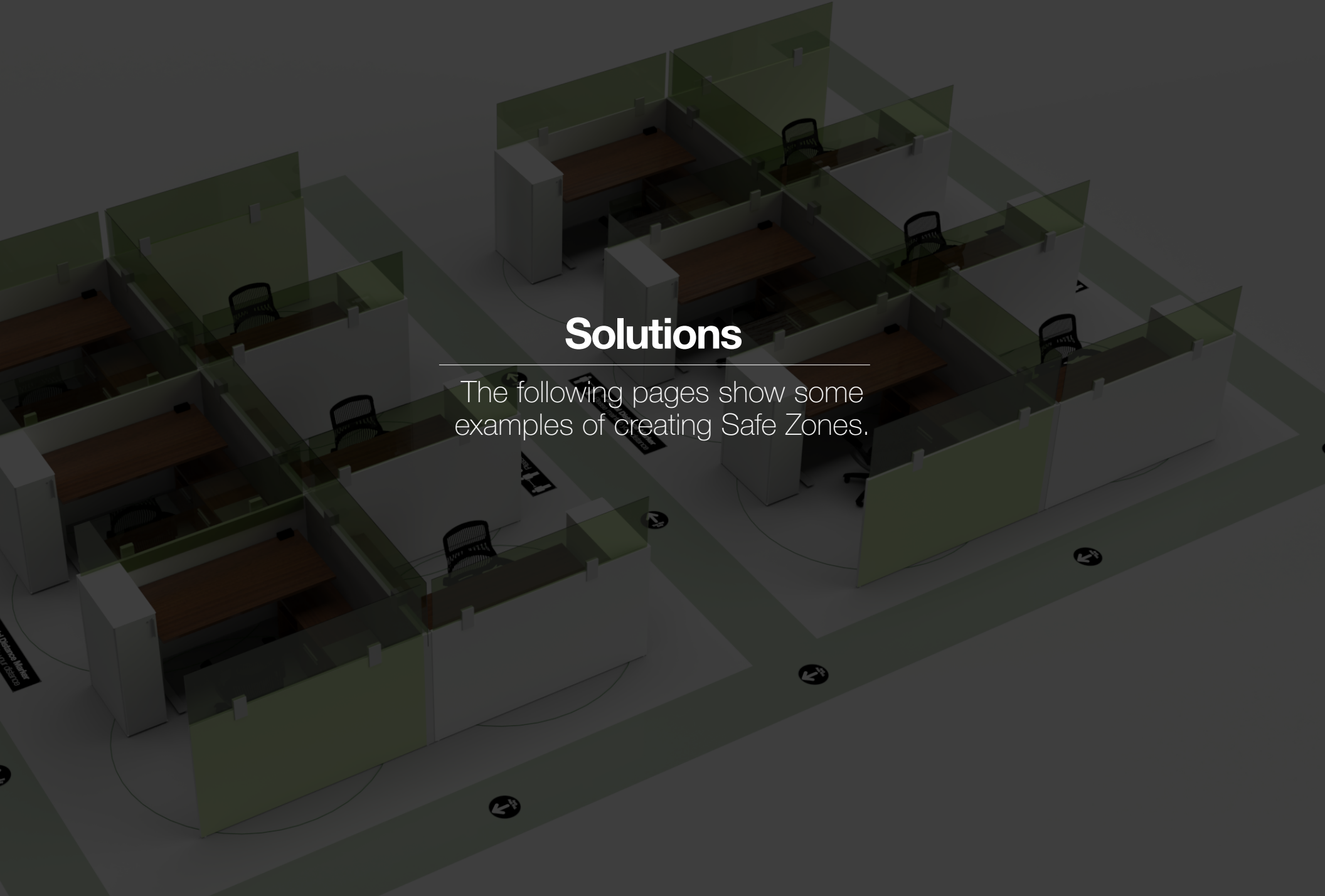

Safe Zones can be created through one of these two methods

Safe Zone Through Barriers

Additions like screens create a physical barrier between associates.

Safe Zone Through Social Distance

Moving people apart, creating a spacial buffer to achieve CDC guidelines.

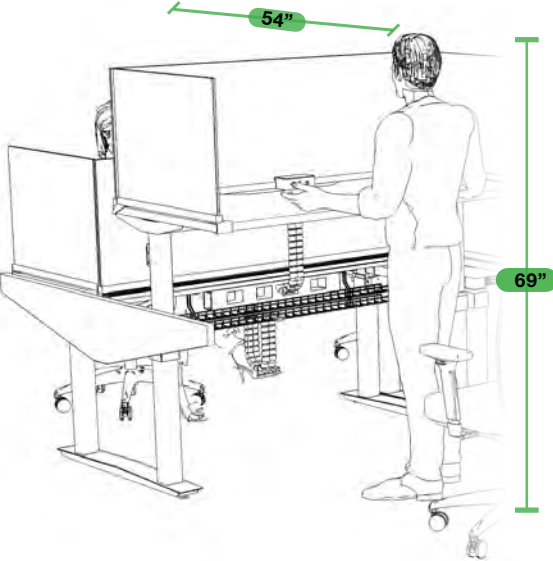

* Average height of:
US male 5'9" / Female 5'3"
According to the CDC.

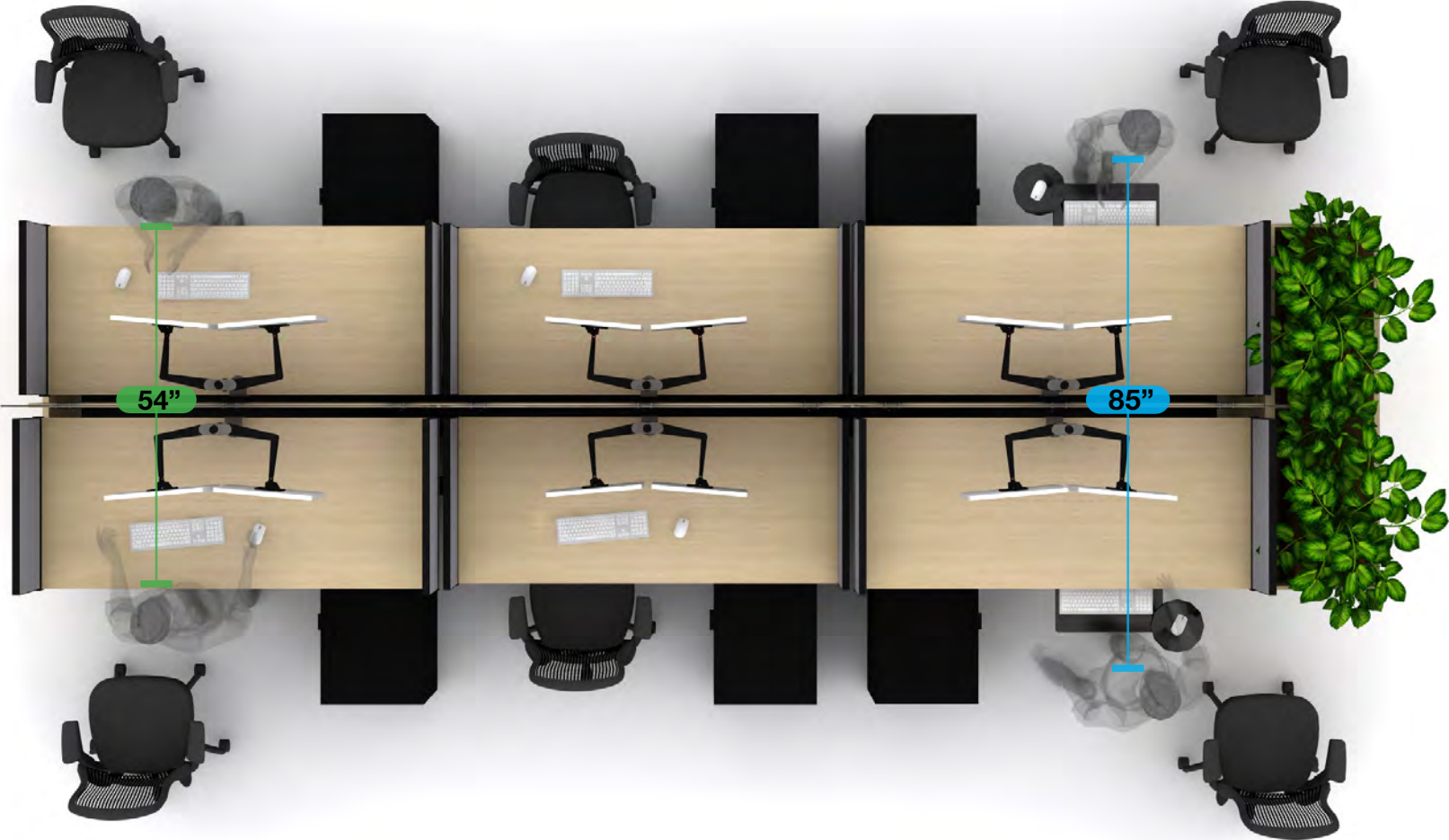

Arenson
**Creating
Safe Zones**
Panel Based
With Return
Example

Original Configuration



Safe Zones Adjustments

Examples of Adjustments made to create Safe Zones

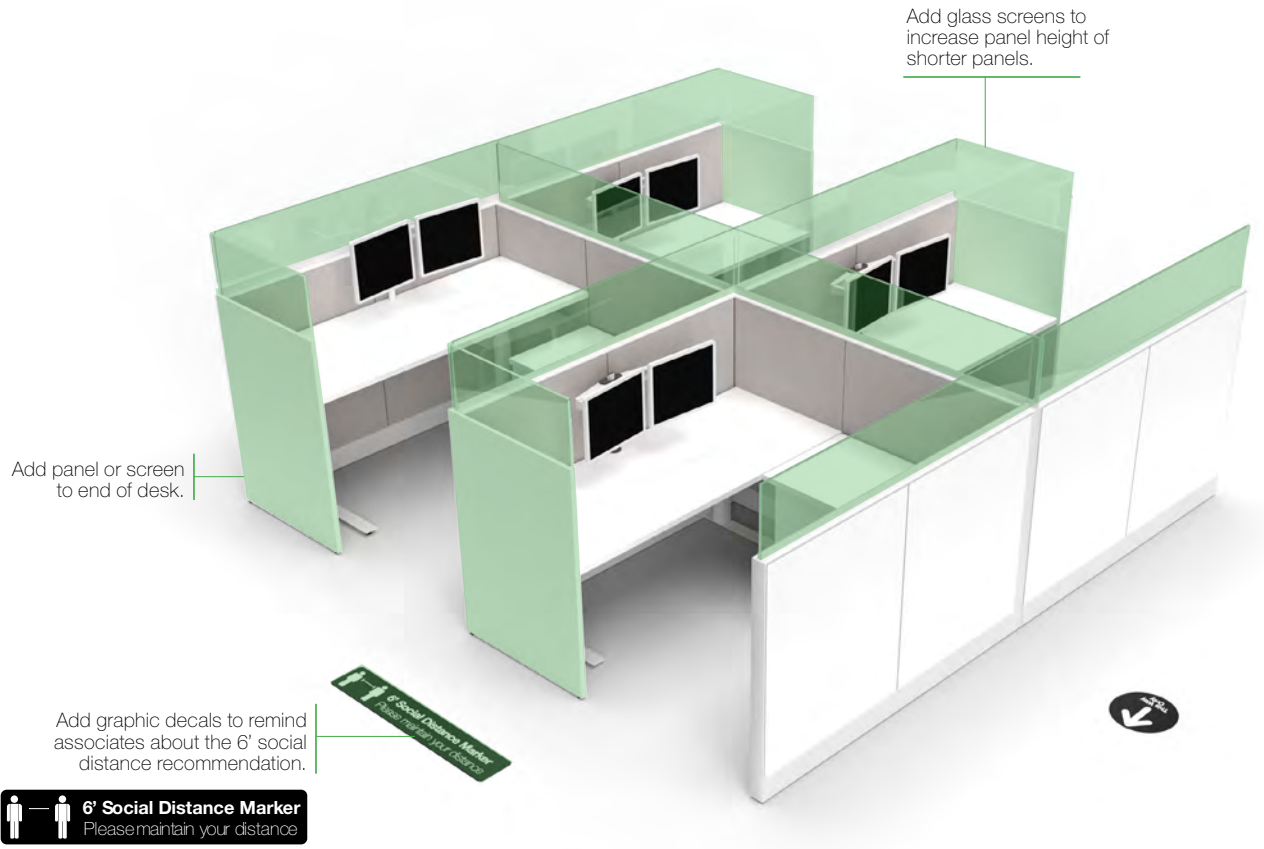

Add panel or screen to end of desk.

Add glass screens to increase panel height of shorter panels.

Add graphic decals to remind associates about the 6' social distance recommendation.



Add graphic decals with clockwise walking flow guides.



Color Legend
● Safe Zone Through Barriers Example

Original Configuration



Safe Zone Adjustments

● Examples of Adjustments made to create Safe Zones

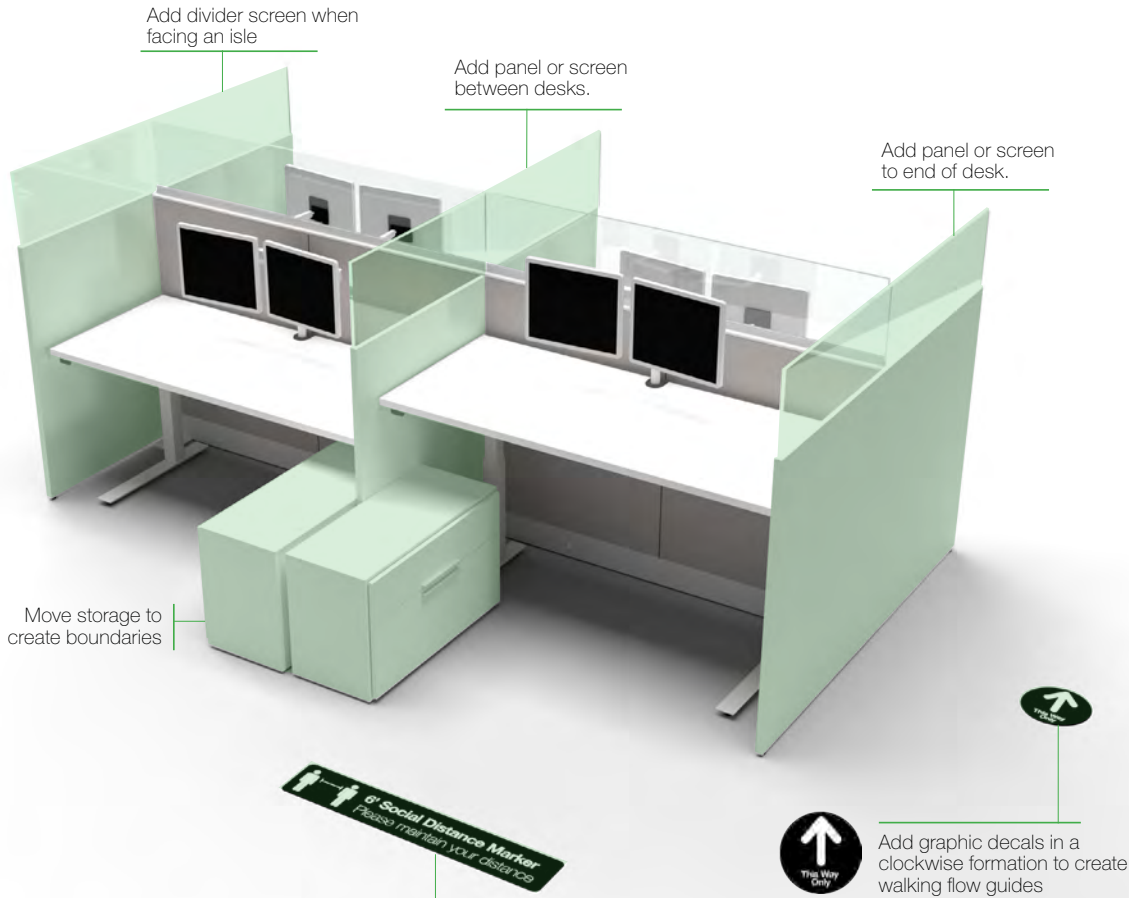

Add graphic decals to remind associates about the 6' social distance recommendation.



Add graphic decals in a clockwise formation to create walking flow guides

Original Configuration



Safe Zone Adjustments

Examples of Adjustments made to create Safe Zones

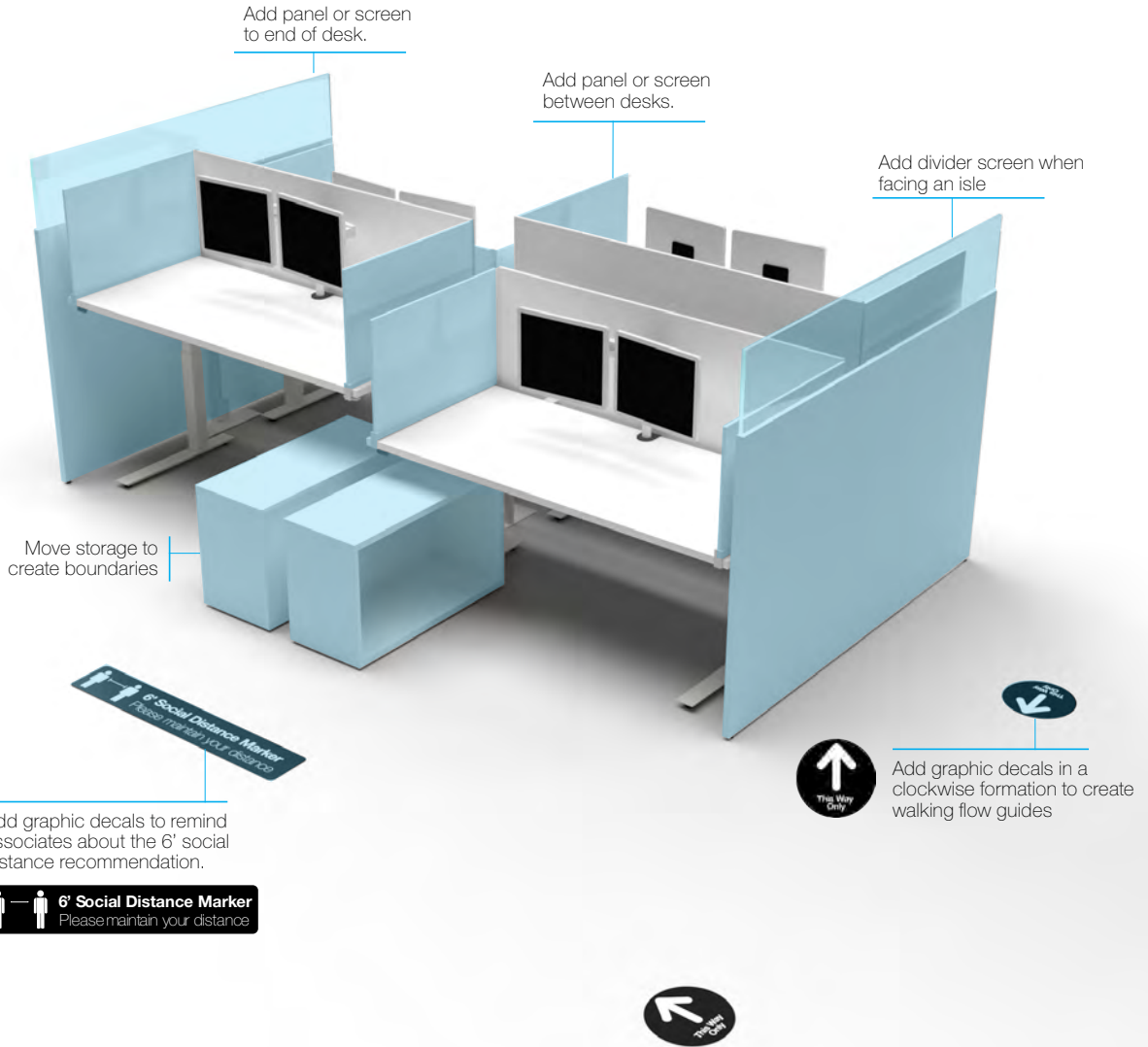

Add graphic decals to remind associates about the 6' social distance recommendation.



Add graphic decals in a clockwise formation to create walking flow guides

Original Configuration



Safe Zone Adjustments

Examples of Adjustments made to create Safe Zones



Decommission guest seating



Add graphic decals to remind associates about the 6' social distance recommendation.



Add graphic decals with maximum capacity for Private Offices and conference rooms.



Original Configuration



Safe Zone Adjustments

Examples of Adjustments made to create Safe Zones

Rearrange Seating to maintain 6' of distance



Add graphic decals in a clockwise formation to create walking flow guides

Add screens between people.

Add graphic decals to remind associates about no seating areas

 **Please Do Not Sit Here**
To Maintain Social Distance

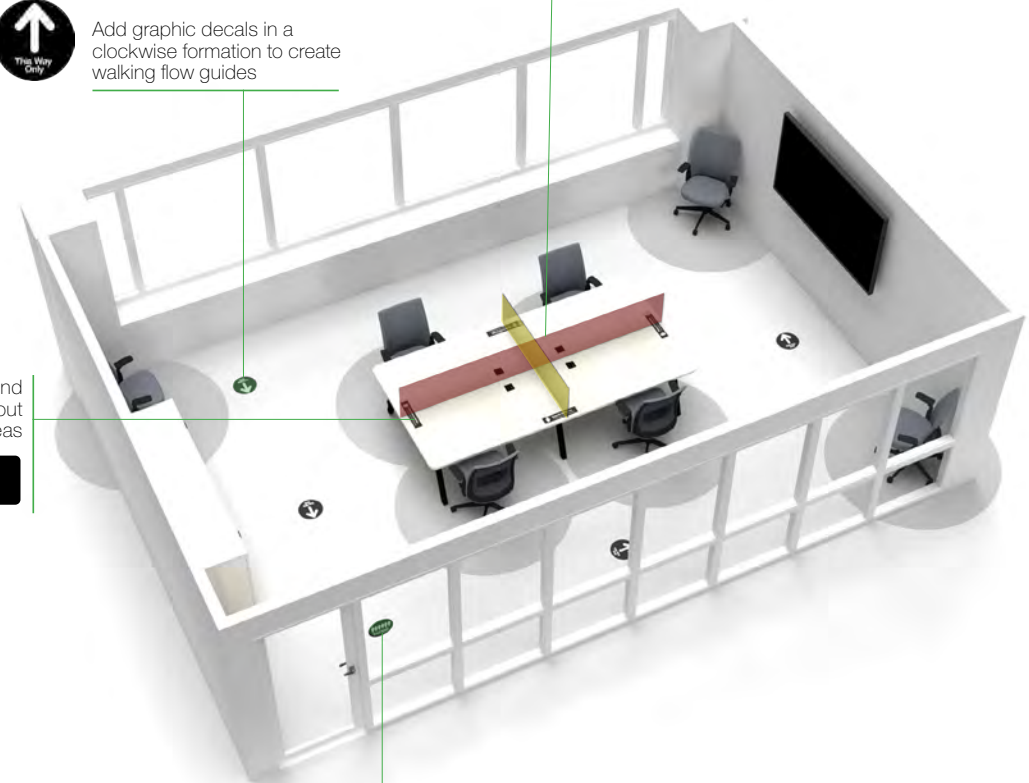

Add graphic decals stating rooms maximum capacity

Options

The following pages include samples of products that may be utilized to create Safe Zones.

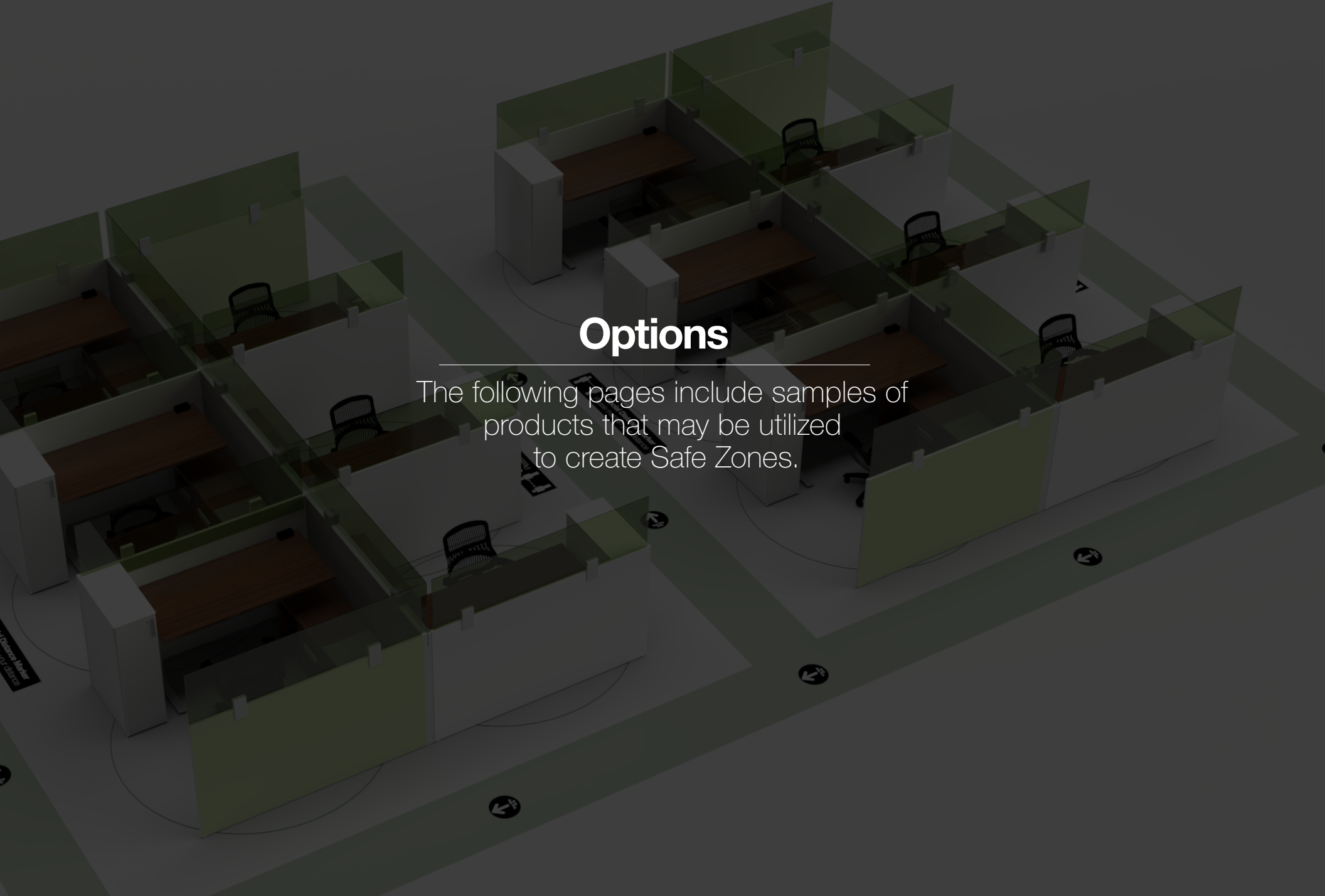

Barriers for Desking

The images below represent only a few examples of the many products available to safely separate staff at their desk. These products are available in various materials (*Glass, Acrylic, Fabric, Felt and felt like, Laminate, Wood etc.*) and sizes. Selecting the correct product should only come after adherence to a protocol, understanding the correct placement, and determination of the structural attachment of these barriers.

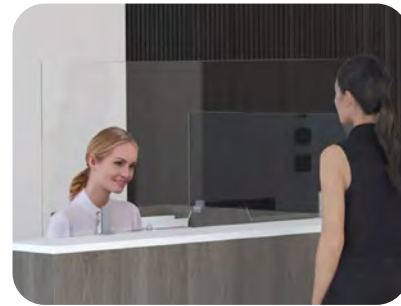
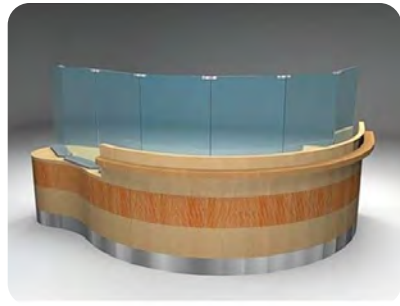
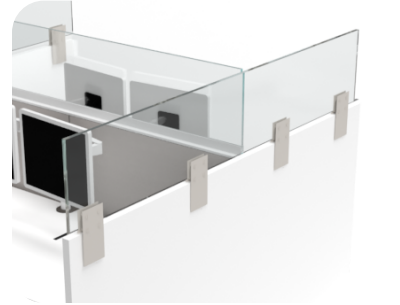

Barriers for Dividing Space

The images below represent only a few examples of the many products available to safely separate staff in open areas. These Barriers are available in various materials (*Glass, Acrylic, Fabric, Felt and felt like, Laminate, Wood etc.*) and sizes. Selecting the correct Barrier should only come after adherence to a protocol, understanding the correct placement, and compliance with the manufacturers guidelines for use, and installation.

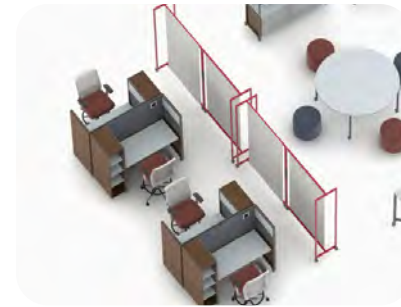
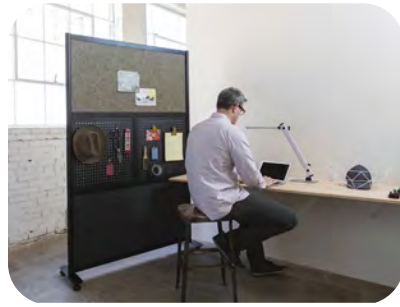

Signage Package:

We've developed a library of graphics with health tips to your associates navigate throughout your space while maintaining the social distance guideline of 6' advised by the CDC.

Lobby / Welcome

Signs outlining your office policy, making visitors/ associates aware of the different graphics around the office.



Office Flow

Different graphics showing circulation paths, waiting areas, the maximum amount of people allowed in different rooms.



Instructional

Graphics demarcating social distancing measurements



Arenson Is Here To Help

Arenson is a workplace expert. We understand products, spacial relationships and are up to date on the most recent government regulations and recommendations. We can provide guidance and expert solutions to best protect your staff and your company.

Rosemary Farrell
Senior Account Executive
516.707.1955 **direct**
rfarrell@aof.com

Kevin Kennedy
Executive Vice President
917.379.5796 **direct**
kkennedy@aof.com

Business Continuity

Make your employees feel safe

**When you come
back to the office
feeling safe is going
to be priority one.**

Distinctive Offices can help.
We specialize in refreshing occupied
office space without disrupting business

Services

Carpet replacement
to assist with new
traffic patterns

A Fresh coat of paint
to refresh the
environment

Antimicrobial paint
for the hi touch
areas

Furniture
reconfiguration to
adhere to social
distancing guidelines

Plexiglass dividers
between seating and
walkways

Turn large open
areas into smaller
private workspaces

Design

Budgeting

Tell your clients what we tell ours,
“Don’t Move Just Feel Like you Did”

Before



After



The background features abstract, overlapping geometric shapes in various shades of green, ranging from light lime to dark forest green. The shapes are primarily triangles and polygons, creating a dynamic, layered effect. The overall composition is clean and modern.

Distinctive Offices, Inc.
250 40th Street, Ninth floor
New York, Ny 10018

Richard V Colucci, President
917-416-6161
distinctiveoffices.com



ECS Presents Puro Lighting

Killing Viruses Through On-Demand & Automated
UV Disinfection

About ECS

Leaders in Energy Efficient Lighting and Controls Since 1995

Turn-Key Services

Direct Distributor of All Major Lighting Brands

In House Project Management & Installations

Markets Served: Commercial, Industrial, Retail, Grocery, Healthcare,
Hospitality, Education & Multi-Family





Puro UV Light Product Highlights



- Designed to be installed in recessed, surface or as a mobile unit
- BACnet Compatible for BMS integration & Automation
- Effective in as little as 15 minutes
- Built-in motion sensor that will deactivate the unit if triggered.
- Chemical Free Disinfection
- F1 Uses 40W over 1 Hour and F2 120W @ 120V



Where Can We Use It?

- Puro Violet Defense technology is best utilized in high touch/high traffic areas.
- Mail Rooms
- Waiting Rooms
- Cafeterias
- Schools
- Lobbies
- Elevators
- ATM Vestibules
- Fitness Centers

How Does UV Light Kill Viruses?

-  Sterilization / Antiviral
240-360nm
-  Antimicrobial / Antibacterial
360-430nm
-  Commercial / Residential
450-475nm

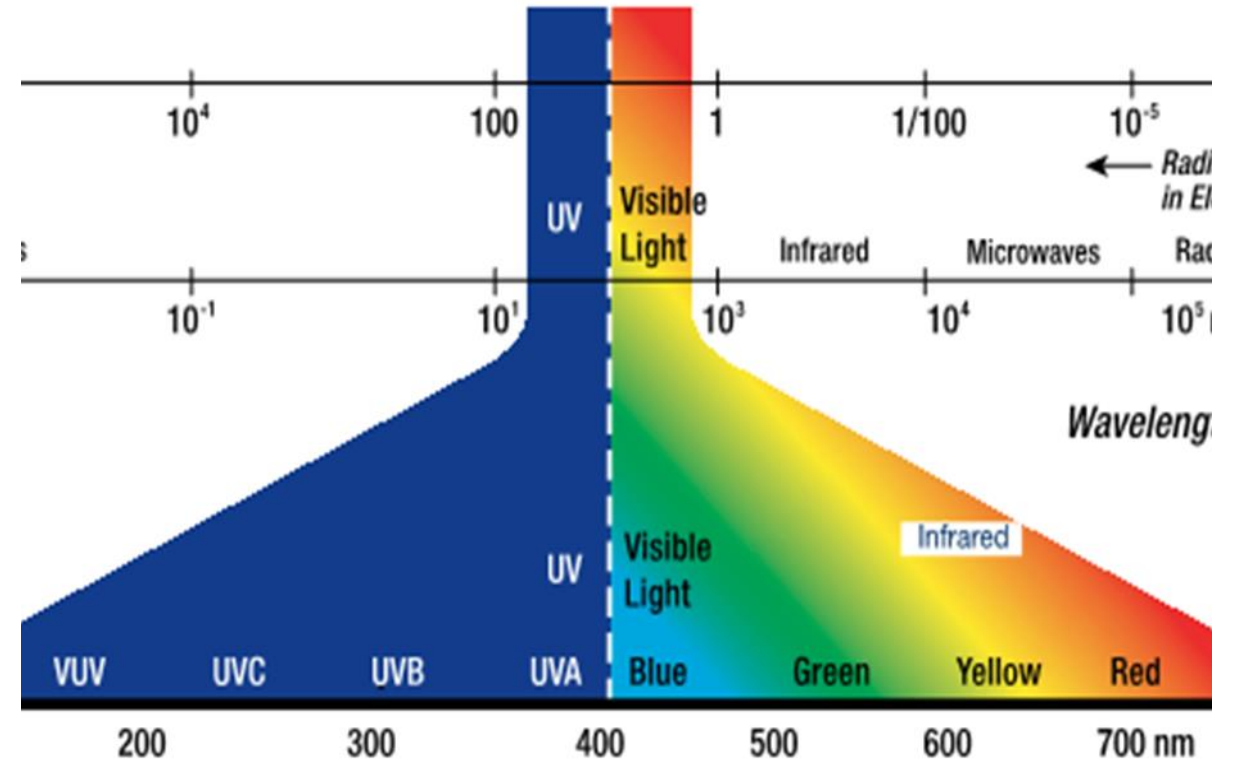

Puro Lighting uses “Violet Defense” technology. It utilizes germicidal UV-C, UV-B, and UV-A to optimize its germ-killing efficiency.

It's Verified

- Per the EPA emerging pathogen guidelines and based on clinical testing completed, Puro UV lights have efficacy against Class 2 and 3 viruses, including coronaviruses, SARS, Influenza and Ebola.



Certifications

- Internal components of this device are UL Listed, UL Recognized or CE listed.
- The manufacturer is registered with the US Environmental Protection Agency (EPA). Clinical laboratory testing has been performed at independent labs.



This device is tested and certified by TUV to UL specifications.



Tested to be compliant with FCC Part 15 Class A.

CASE STUDY

MTA to use ultraviolet lights to kill coronavirus on NYC subways & buses.

<https://www.nydailynews.com/coronavirus/ny-coronavirus-uv-lamps-subway-buses-mta-20200503-vwx6nmxfjbgmlpr2kojnskbvk4-story.html>





Couple a self-contained UV reflective tent with Puro UV disinfection lights.

Disinfect any object on-demand in safe and controlled environment.

Portable Disinfection Tents are great Turn-Key solutions for mail rooms, construction site tools, children's toys, office supplies and many others...



Elevator Sterilization



Restroom Sterilization



Fitness Center Sterilization

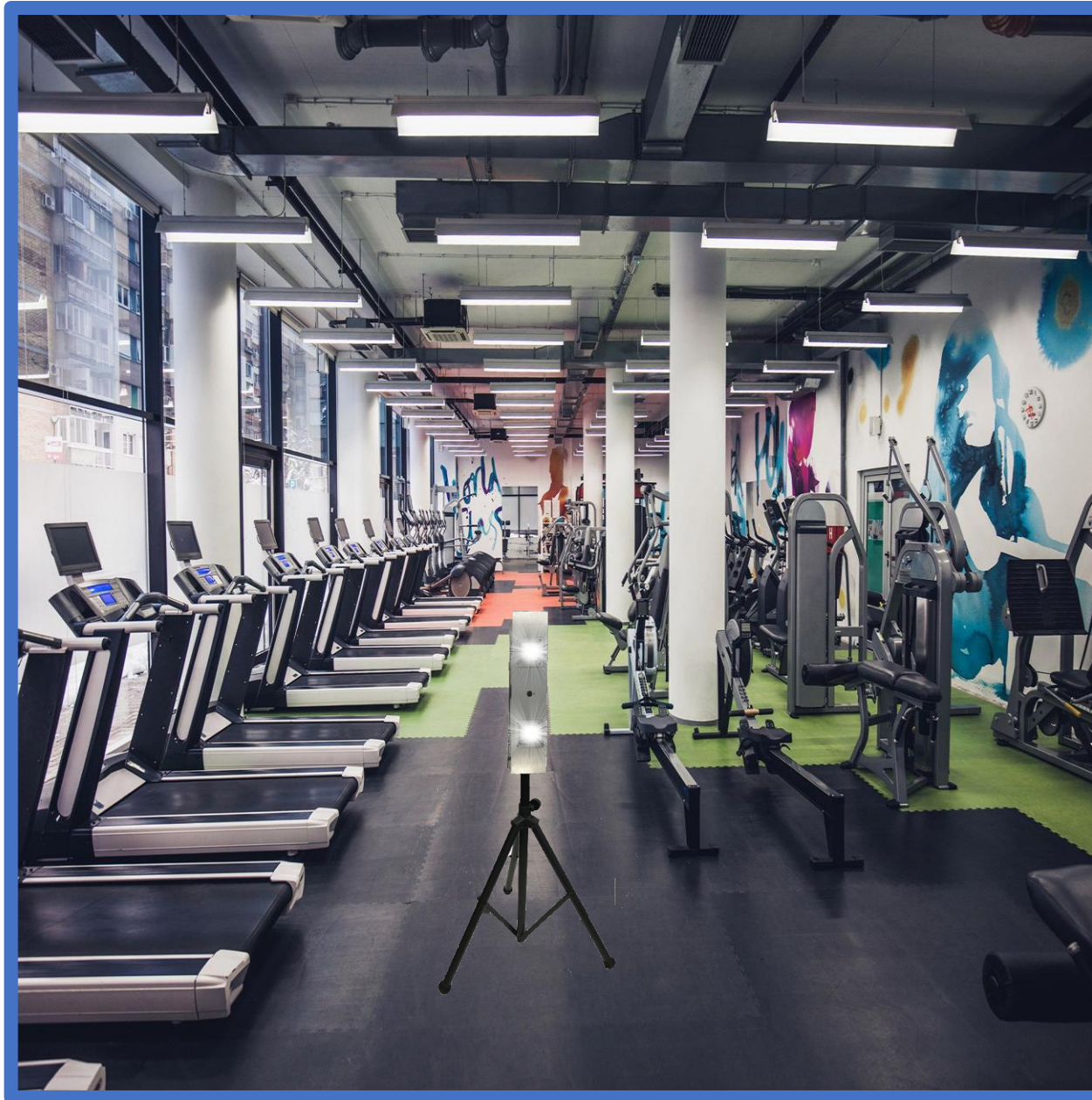

Units In Stock at ECS Warehouse
Leasing and Financing Options Available



Contact us at ricky.dweck@enerconsupply.com for more information.

REOPENING THE WORKPLACE SAFELY AND SUSTAINABLY WITH WEEKS LERMAN

- PPE SUPPLIES
- OFFICE SUPPLIES
- COFFEE & BREAK ROOM SERVICES
- MANAGED PRINT SERVICES
- FURNITURE, DESIGN & SPACE PLANNING
- PRINTING & PROMOTIONAL ITEMS
- JANITORIAL & CLEANING SUPPLIES
- TABS
- ECO-FRIENDLY SUPPLIES



MARC SIEGEL



REOPENING THE WORKPLACE SAFELY AND SUSTAINABLY

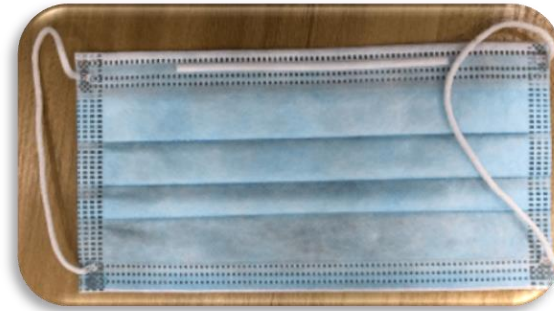

DISPOSABLE MASKS



REUSABLE WASHABLE MASKS

SUSTAINABLE MASKS

WASHABLE SUSTAINABLE MASK FOR YOUR STAFF

Double Knit Mask - 14.9oz double knit polyester

Available in White, Black or Navy

Moisture Wicking Properties / Soil Resistant

Heavy Weight 14.9 oz. Ponte Double Knit 100% Polyester

Stretchable: this product can fit over an N95 (ask medical workers have done)

Two Earholes to accommodate different face shapes/sizes

Washable / Re-usable

American Made – 7-10 Day Lead Time

OPTIONS:

BLANK, ONE COLOR, FULL COLOR



REOPENING THE WORKPLACE SAFELY AND SUSTAINABLY

WASH YOUR HANDS...REFILL YOUR SANITIZERS

PURELL

1200 mL Refills Touch-Free Hand Sanitizer Dispensers

GOJO® LTX™ Smart Dispensers

- GOJO SMARTLINK™ technology is built directly into LTX touch-free dispensers, allowing facilities to utilize the full portfolio of GOJO soaps and sanitizers with our SMART solutions.
- Large sight window makes it easy to check refill level
- High-capacity output
- Converts to a locking dispenser – key included
- Lifetime guarantee
- Fully ADA compliant
- Available for customization
- Multiple colors and finishes available

1200 mL Refills for PURELL® LTX-12™ Dispenser

- Ultra Nourishing™ Luscious Foam
- Standard Foam
- Green Certified Foam and Gel option

REFILL THESE USING THE GALLON



Branded Commercial Hand Sanitizer



GLOVES ARE NOT SUSTAINABLE



HANDS FREE & HOLDS 4 GALLONS OF SANITIZER

SUSTAINABLE OPTIONS

INDIVIDUALLY WRAPPED CUTLERY

Individually Wrapped Utensils (Case = 1,000)



Dispenser



Individually Wrapped Cups (Case= 1,000)



Individually Wrapped Creamers



REUSABLE WASHABLE CUTLERY



SUSTAINABLE OPTIONS



WATER BOTTLES



TEMPERATURE SCREENING SYSTEMS

NON-CONTACT INFRARED THERMOMETER JXB-178

1 Second Testing

- QUICK
- SIMPLE
- ACCURATE

4 IN 1

- BODY TEMPERATURE
- SURFACE TEMPERATURE
- HIGH TEMPERATURE ALARM
- MEMORIZE 32 TEST DATA



Body Temperature Measurement Solutions



PERSONNEL MANAGEMENT KIOSK

Meridian's Personnel Management Solution features check-in and temperature verification capabilities. The solution can also be programmed for facial identification, with users easily added in a few short clicks. Designed to help protect the health and safety of both employees and guests by preventing anyone with a temperature from entering a facility, alarms can be added to sound when those above the temperature threshold and those without access attempt to enter.

For more information, [CLICK HERE](#) to watch a video.

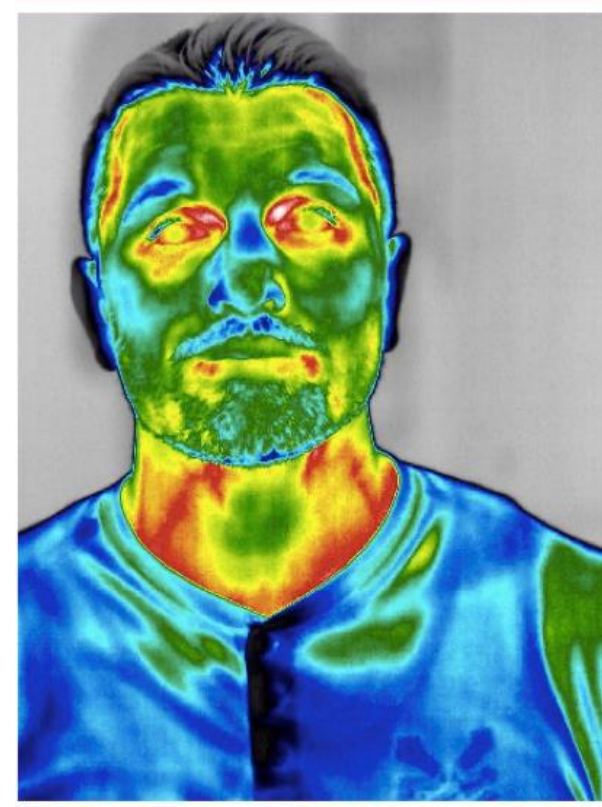

SOCIAL DISTANCING BARRIERS

WE CAN CUSTOMIZE SIZE, SHAPE AND OPTIONS TO MEET YOUR SPECS

Help maintain social distancing and physical separation while protecting employees with our acrylic desk and partition barriers. Acrylic sneeze guards, desk separators, front desk barriers, cough screens and other acrylic and whiteboard partitions are more important than ever to maintain cleanliness in work spaces. We have a selection of panel dividers and mobile rooms dividers that can easily and quickly be added to any commercial area without incurring any costly construction.

We manufacture in the United States with quick turn-around times for large and small quantities.

POTENTIAL SOLUTIONS FOR YOUR BUSINESS

1. CDC recommended hanging graphics
2. Acrylic barriers to protect employees and customers
3. Social distancing floor graphics for castwraps and checkout lines



Lexan Freestanding Screen (Shown on Calibrate® Reception)



Surface Top Transaction Screens

Protective shield/sneeze guard for intake areas and transaction/reception. Mount flush to surface or 2" above surface to support transactions.

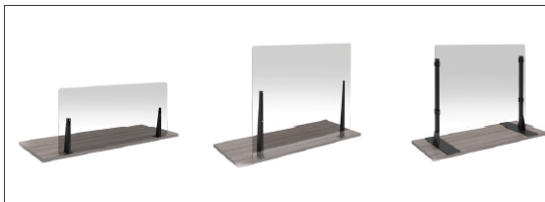

Free standing 24x30 Germ Shields

MODEL & DESCRIPTION:

- ALTSG-24x30 (Germ Shield, 24"W x 30"H). All 1/4" clear acrylic construction. Includes one shield with pass-thru (12"Wx3"H) and two legs. Speaking holes not included (can be drilled in the field if needed)

Custom sizes are available in quantities of 200 or more (lead-times will vary).



Wipeable vinyl
easy to clean!

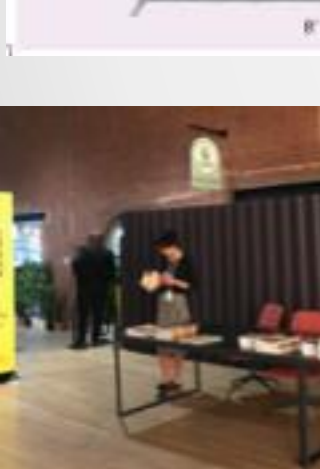

AN OPEN DOOR OPPORTUNITY

With the threat of germ cross – contamination more globally recognized than ever before, the latest survival strategy among today's Away-From-Home patrons has become simple: "Don't touch anything!" Yet, with all the modern "touch-free" advances in washroom hygiene, it's hard to grasp why the door handle has been so universally ignored. Until now. Enter Pürleve™, the innovative door handle solution that offers a clean, sanitary experience for every user . . . every touch, every time.

Employing a proprietary Automatic Sleeve Dispenser (ASD) technology for either a Push-Pull or Lock / Latch door, Pürleve automatically advances an antimicrobial sleeve over the handle with every use. Finally, visitors to washrooms and other public areas are no longer affected by the questionable hygiene habits of all the people who have gone before them.

PÜRLEVE helps 'DECREASE CROSS CONTAMINATION & MAXIMIZE HEALTH & HYGIENE.'

- 1 in 3 People do not wash their hands after using the washroom...
- 80% of infectious illnesses are transmitted by touch...
- Within one hour 1,000 bacteria on a handle becomes 16,000 — it takes only 100 bacteria to infect a person...
- Compliance for hand washing in most hospitals is only 40%...

When it comes to germs and cross- contamination, the numbers speak for themselves. Cross-contamination occurs when germs are spread from one person to another simply by touch—directly or indirectly. Once a surface is touched, bacteria are transferred to it immediately.



PÜRLEVE helps 'ENHANCE WASHROOM IMAGE'

Pürleve's hygienic door handle supports the elimination of the unsightly mess of wet, dirty paper towels that end up on the floor and overflow the washroom receptacles. As the final piece in an increasingly in-demand collection of advanced, automated washroom fixtures, Pürleve aids in improving public hygiene, minimizing cross-contamination and promoting the image of a clean, healthy environment among guests.



PÜRLEVE is 'GREEN'

At Pürleve™, we support the global green initiative. Hygienic Door Handle systems incorporate lead free electronics and low-power systems resulting in reduced energy consumption to efficiently drive the technology within. The door handle refills use no paper and the antimicrobial sleeve material that each handle advances is 100% recyclable. Support in the reduction of Paper Towel consumption.



PROTECT YOUR EMPLOYEES AND CUSTOMERS FROM COVID-19

SOCIAL DISTANCING SIGNS AND DECALS

NOTICE

WASH YOUR HANDS BEFORE RETURNING TO WORK

PLEASE

WIPE DOWN AREA REGULARLY

PLEASE STAY

6 FEET AWAY

CART WIPES

PLEASE USE ONE WIPE PER CART THEN THROW AWAY IN THE BIN PROVIDED

HELP US HELP YOU STAY SAFE!

CV-1 8" X 8"
CV-2 12" X 12"

CV-3 8" X 8"
CV-4 12" X 12"

CV-5 8" X 8"
CV-6 12" X 12"

CV-7 8" X 8"
CV-8 12" X 12"

FLOOR DECALS

STAY SAFE

6 FEET APART!

SUPPORT SOCIAL DISTANCING

CV-11 12" DIA.

STAY SAFE

6 FEET APART!

SUPPORT SOCIAL DISTANCING

CV-11 12" X 14"

STOP

PLEASE WAIT HERE UNTIL CALLED FORWARD

CV-9 7" X 10"

CHOOSE FROM ONE OF OUR DESIGNS OR CREATE ONE THAT MEETS YOUR NEEDS!

SORRY!

DINING ROOM IS CLOSED BUT WE ARE OPEN FOR TAKEOUT



Protect Your Customers and Employees

- Floor Graphics & Wayfinding Signage
- Stop the Spread Signs and Posters
- Maximum Occupancy Signage
- Staff Welcome Signage
- Breakroom Table Signage
- Front Entrance Window Clings
- One-way Traffic Flow for Hallways
- Professional Installation Available



StandSafe™ Personal Spacing Disks

Protect customers and clients from COVID-19 and other virus exposures by ensuring they maintain a safe distance while standing in line. StandSafe™ repositionable vinyl disks provide durable performance and flexible design for customer lines.



Help Customers Maintain Proper Social Distance

- StandSafe™ repositionable vinyl disks provide durable performance and flexible design for customer lines
- Exclusive SuperGrip™ coating keeps mat in place; restore by wiping clean with wet cloth
- Safe for use on low-pile and commercial grade carpets, tile, and other hard floor surfaces*
- Disks are GreenGuard Gold certified for clean air emissions and part of the USDA BioPerferred Program containing 30% USDA certified biobased content
- Disks are customizable with your logo or desired design and color palette. Minimum quantities apply.

* Do not use on laminate or hard wood flooring as SuperGrip coating may damage surface finish

Social Distancing Signage

CHOOSE FROM ONE OF OUR DESIGNS OR CREATE ONE THAT MEETS YOUR NEEDS

MAXIMUM 2 PEOPLE AT A TIME

THANK YOU FOR PRACTICING SOCIAL DISTANCING

CV-8 18"X18"
CV-4 12"X12"

MAXIMUM 2 PEOPLE AT A TIME

THANK YOU FOR PRACTICING SOCIAL DISTANCING

CV-8 18"X18"
CV-4 12"X12"

MAXIMUM OCCUPANCY OF 3 PEOPLE

THANK YOU FOR PRACTICING SOCIAL DISTANCING

CV-4 24" X 36"
CV-8 12" X 18"

MAXIMUM OCCUPANCY OF 4 PEOPLE

THANK YOU FOR PRACTICING SOCIAL DISTANCING

CV-7 36" X 36"
CV-8 12" X 18"

STOP THE SPREAD OF CORONAVIRUS

PROTECT YOURSELF AND OTHERS AROUND YOU

PLEASE KEEP YOUR DISTANCE

THANK YOU FOR PRACTICING SOCIAL DISTANCING

CV-9 48" X 96"
CV-10 24" X 48"

COVID-19

WASH YOUR HANDS BEFORE RETURNING TO WORK

CV-10 12" X 12"
CV-18 18" X 18"

PLEASE WIPE DOWN AREA REGULARLY

CV-17 12" X 12"
CV-18 18" X 18"

COVID-19 Social Distancing

PLEASE KEEP YOUR DISTANCE

CV-19 24" X 36"
CV-20 12" X 18"

STOP

PLEASE WAIT HERE UNTIL CALLED FORWARD

CV-21 14" X 20"
CV-22 17" X 19"

Exterior Grade Floor Graphics

CHOOSE FROM ONE OF OUR DESIGNS OR CREATE ONE THAT MEETS YOUR NEEDS

BE SMART STAY 6 FEET APART

CV-23 18" X 18"

BE SMART STAY 6 FEET APART

CV-24 24" X 36"

PLEASE PRACTICE SOCIAL DISTANCING

CV-25 18" X 18"

PLEASE PRACTICE SOCIAL DISTANCING

CV-26 18" X 18"

ONE WAY AISLE

CV-27 18" X 18"

STOP SMART STAY 6 FEET APART

CV-28 18" X 18"

STOP SMART STAY 6 FEET APART

CV-29 18" X 18"

STAY SAFE SOCIAL DISTANCING

CV-30 18" X 18"

WAIT HERE UNTIL CALLED FORWARD

CV-31 18" X 18"

WAIT HERE UNTIL CALLED FORWARD

CV-32 18" X 18"

MAINTAIN 6 FEET SOCIAL DISTANCE

CV-33 18" X 18"

SIGNAGE

SOCIAL DISTANCING BARRIERS

WE CAN CUSTOMIZE SIZE, SHAPE AND OPTIONS TO MEET YOUR SPECS



TensabARRIER® Advance Post

Ideal for organizing queues and putting into practise good social distancing in all customer facing environments. Position posts 6 feet apart as an indication to customers on how far apart they should be standing from the person in front of them.



Safe Distance Floor Markers

A solution that can quickly be deployed around entrances and exits, general areas and within queues to help customers identify a safe distance to stand when queuing or walking through your environment.

TensabARRIER® Post Top Signage

Simply slot on top of your TensabARRIER post to communicate important safety messages with your customers without human contact. Ideal for advising customers to stand 6 feet apart from the person in front of them.



TensabARRIER® Post Top Labels

Customize any of our TensabARRIER® posts with a custom post top label reminding customers of key tips to fight the spread of Coronavirus. Examples of this: wash hands frequently, catch it bin it kill it, avoid touching eyes nose mouth, keep 6 feet apart from the person in front of you.

Road Cone

Tensator traffic cone can be placed in virus drive-up or walk-in testing zones to indicate where people should wait. It has a secure base and outdoor-ready material construction that makes it applicable to both indoor and outdoor use. Can be easily manipulated to create different queue layouts as needed and is compact enough to stow for transport or storage.



WE CAN CUSTOMIZE SIZE, SHAPE AND OPTIONS TO MEET YOUR SPECS

Tensator® Titan Barricade

A strong and effective solution, ideal for managing crowds of people or preventing access to areas. Hook and eye locking system connects the fences, making them harder for crowds to move.



Cleaning in Progress

Authorized Access Only

Caution - Do Not Enter

No Entry

Emergency Exit

TensabARRIER® Printed Webbing

All of our products can be made with eye-catching safety messages to help keep your customers and employees safe while on-site during this pandemic.



300 Plastic Post

A lightweight, clearly visible option to show where queues should form or can be used to cordon off unsafe or restricted areas. It is available in yellow, black or white color options and short or long chain lengths depending on spacing needs. Plastic composition makes it ready for outdoor or indoor use.

Also available in Black and White finishes



TensabARRIER® Wall Units

Quickly and efficiently cordon off out of service areas to the public. Ideal for clearly defining routes and restricting access to areas that you want to cordon off and can fix to most surfaces either semi-permanently or permanently.



TensabARRIER® Facility Post

Ideal for outside or back of house areas, limit customer access or create safe zones for your warehouse staff. The post and base can be easily dismantled without the use of tools, for easy storage and transportation.



BACK TO WORK KITS



- American-made, double-knit 14.9 oz. mask (available in black, white or navy)
- 1 fl oz. Antibacterial gel packet/sanitizer (white or silver) (personalization not available)
- 80% Alcohol Antiseptic Wipe (personalization not available)
- Pair of Gloves
- All items packaged in 210 denier nylon zipped pouch (available in red, white, green or blue)
- Price includes a 1 color imprint on bag and mask.

BACK TO WORK KITS

CUSTOMIZABLE OPTIONS AVAILABLE

CONTACT US

Let Us Help...

If you currently work with Weeks Lerman, please contact your sales rep

Marc Siegel



58-38 Page Place, Maspeth NY 11378



(516) 637 3544



msiegel@weekslerman.com



HOSPITALITY IN THE TIMES OF COVID-19

PREVENTION & PREPAREDNESS ON REOPENING HOTELS TO GUESTS AND ASSOCIATES

MIRIAN ORTEGA , COMPLEX DIRECTOR OF SALES @ LE MERIDIEN NEW YORK CENTRAL PARK

MIRIAN.ORTEGA@LEMERIDIENNYC.COM 917-935-8772

REOPEN HOTEL DOORS



PHASE 1 OF CONSIDERING REOPENING OF A HOTEL

- EXTENSIVE WALK THROUGH OF HOTEL, INSPECTION OF ALL GUESTROOMS, FLOORS, PUBLIC SPACES AND GENERAL MAINTENANCE ON MACHINERY AND EQUIPMENT
- PMI OF INVENTORY/GUESTROOMS SCHEDULE TO BE READY FOR GUESTS (50% OF THE HOTEL GUESTROOMS)
- DEEP CLEANING OF CORRIDORS, CARPETS AND GUESTROOMS LINEN, ELEVATOR MAINTENANCE AND CLEANING, NEW OFFICE SET UP, SIGNAGE FOLLOWING RECOMMENDATIONS OF OUR PARTNERS AT
- ECOLAB REGARDING GENERAL CLEANING AND INSPECTION CHECK LISTS PRIOR OPENING

PHASE 2 OF CONSIDERING REOPENING OF A HOTEL

- CALL OUR ASSOCIATES BACK TO WORK WITH TWO WEEKS NOTICE
- PREPARE FOR OUR ASSOCIATES ARRIVAL, PPE (PERSONAL PROTECTIVE EQUIPMENT) FOR ALL ASSOCIATES
- SIGNS FOR ELEVATORS, SIGNS ON FLOORS FOR GUESTS ABOUT SOCIAL DISTANCING , PURCHASED ELECTROSTATIC SPRAYER FOR ALL PUBLIC SPACE AND CHECKOUT ROOMS
- TRAINED ALL EMPLOYEES FOR ENHANCED COVID-19 PREVENTION AND PREPAREDNESS
- TRAINED ALL HOUSEKEEPING TEAM ON ENHANCED CLEANING PROCEDURES
- COOLING TOWARDS MAINTENANCE, INSTALLED SCREEN COVER FOR FRONT DESK CHECK IN AREA

CONTINUED.....

PHASE 3 OF CONSIDERING REOPENING OF A HOTEL

- CHECK-IN OPTIONS : DIGITAL C/I OPTIONS THROUGH YOUR MOBILE APP
- PUBLIC SPACE MAINTENANCE AND CLEANING CHECK LIST NOW DUE EVERY 20 MINUTES
- OFFICE SPACE PROTOCOL: POSITIONS THAT CAN BE PERFORMED REMOTE WILL REMAIN REMOTE FOR THE UPCOMING MONTHS: SALES, REVENUE, ACCOUNTING
- OPENING 50% OF THE HOTEL WITH LIMITED AMENITIES WILL REQUIRE ONLY HALF OF OUR ASSOCIATES TO RETURN TO ON PROPERTY WORK
- ASSIGN GUESTS TO DIFFERENT FLOORS ALLOWING THEM SPACE BETWEEN OTHER GUESTS
- ACCESS TO OUR WEBSITE PORTAL FOR ALL ASSOCIATES ON NEW BEST PRACTICES FOR SAFETY OR OUR GUESTS AND EMPLOYEES

Specific touchpoints

- Doorknobs
- Light switches
- Thermostat
- Phone
- TV and remote control
- Safety latch and peephole
- Chair armrests
- Toilet flush lever
- Shower handles
- Safe and lock
- Luggage rack
- Iron
- Compendium
- Drawers (inside/out)
- Nightstands
- Mini-bar



ADJUSTING DAILY LIFE WITH NEW CHANGES



MEETINGS & EVENTS CHANGES

SIGNATURE AND HYGIENE



NEW CAPACITY, NEW DIAGRAMS

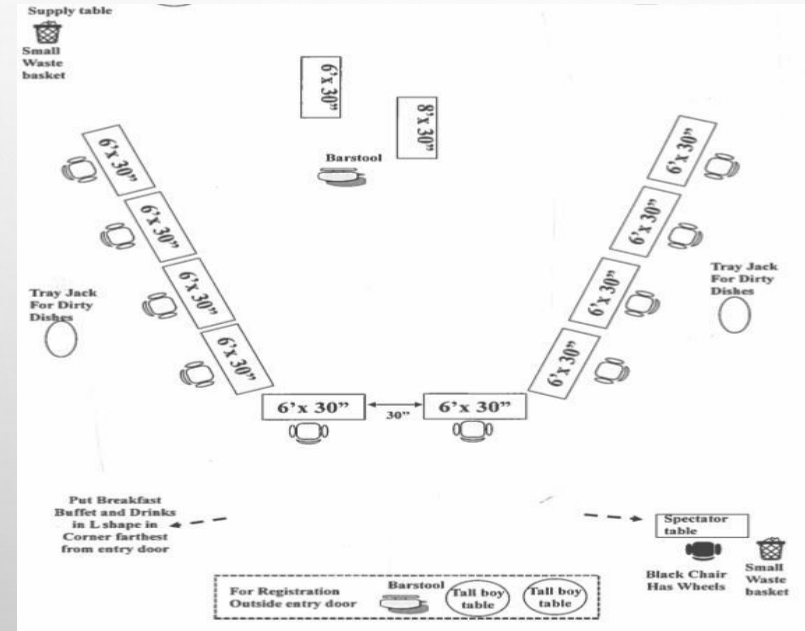

MORE PERSONAL SPACE FOR OUR GUEST SAFETY

